



TRITON CONTROLS

DS-50 SERIES

FLUSH MOUNTED
MINIATURE RADAR
SENSORS



A NEW GENERATION OF TRITON RADAR SENSORS

- ***Long reach and wide approach detection***
- ***Robust weatherproof design***
- ***IP 54 Environmental protection***
- ***Adjustable hold open delay***
- ***Wide supply voltage range***
- ***Radar head adjustable in 2 planes***
- ***Relay output, NO or NC contacts available***
- ***Simple to install and adjust***
- ***Suitable for architectural or industrial doors***
- ***Attractive housing***

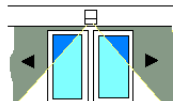

IN CONTROL



TRITON CONTROLS LTD., UNIT 2, RANDOLPH INDUSTRIAL ESTATE, EVENWOOD,
BISHOP AUCKLAND, CO. DURHAM DL14 9SJ

Tel. +44 (0) 1388 833000 Fax +44 (0) 1388 833680

web. www.tritoncontrols.co.uk

e-mail info@tritoncontrols.co.uk

FEATURES

- Two distinct detection patterns are available.
DS50 A semi-circular beam pattern that enables a wide angle of approach as in bi-parting sliding doors.
- **DS51 A** long range narrow beam antenna suited to industrial doors or restricted areas
- CE marked and fully EMC suppressed.
- Versatility of supply. Power Supply
- 11-28.5v AC/DC
- Ease of adjustment. Sensitivity (Range) adjusted by a single easily accessed control.
- Radar head swivels in 2 planes
- Hold open delay adjustable up to 5 secs.
- Simple installation. Equipped with easily accessible screw terminal connector.
- Relay output with change over contacts for fully “volt free” operation
- Controls readily accessible under “snap-on” front cover
- Black anodised aluminium case with dark red acrylic front cover

SPECIFICATION

Power supply 10.5-28.5VAC
10.5-30VDC

Power requirements 2.5VA

Current draw 50mA @24VDC

Output relay...N.O. & N.C. contacts

Max horizontal range up to 10M

Depending on antenna

Mounting height..... up to 4.5M

Depending on model

Transmitter frequency 24.125GHz

Transmitter Power 30mW typical

Protective class nt case IP54

Operating temperature -20 to+50°C

Cable length 2M

LED Indicator lit on activation

Hold open delay adj 0 to 5 secs

OUTER DIMENSIONS

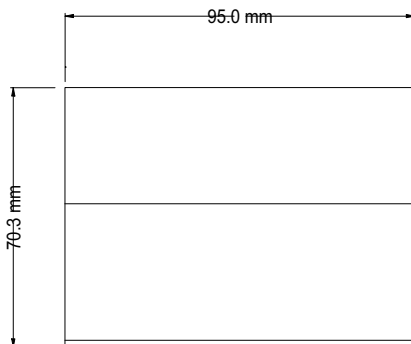

FRONT VIEW

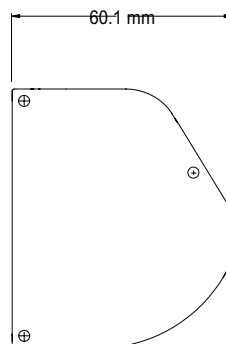

SIDE VIEW

ADJUSTMENTS

The ground plans, figs1 and 2, illustrates the possible coverage patterns depending on range setting and antenna angle.

By adjusting the angle of the antenna the detection pattern can be changed between circular, elliptical lateral to elliptical longitudinal.

The sensitivity control, which is easily accessed from the front of the unit, determines the size, rather than the shape, of the detection area and can, therefore, be regarded as a **Range** control.

Fig 1. WIDE BEAM

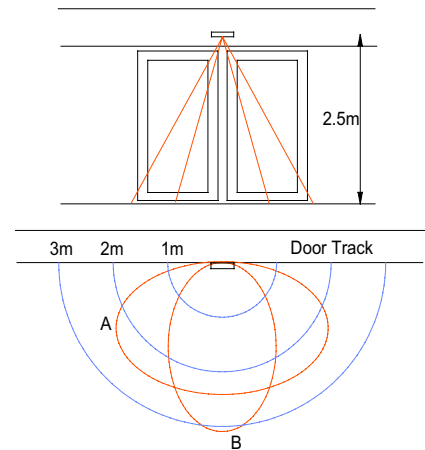

Fig 2. NARROW BEAM

